





FLUOSPOT fittings, made from technopolymer, fit compact fluorescent lamps and grant high energy saving respect to similar products for halogen lamps.

FLUOSPOT are suitable for a wide range of indoor and outdoor applications, wall mounted or installed on the several available brackets: lighting of small advertising panels, signs, billboards and display lighting in general.

*FLUOSPOT Luminarias de tecnopolímero para lámparas compactas de gran ahorro energético, comparado con las luminarias similares de halógenas.*

*FLUOSPOT se instalan en interior y exterior, montadas en pared o en diversas liras y soportes: Iluminación de letreros, anuncios, logos, paneles y planos exteriores.*

# FLUOSPOT



SBP

design Arch. Silvia Paola Pennacchio







FLUOSPOT are small light fittings designed for energy saving compact fluorescent lamps, for indoor and outdoor installations.

The compact fluorescent lamps used as the light source have a high lumen/watt ratio making Fluospot particularly useful when a long lighting time is required.

Fluospot advantageously replace the halogen lamps fittings for lighting shop fronts, advertising signs and internal commercial etc..

The technopolymers used in the manufacture of Fluospot are corrosion resistant and can also be installed in marine applications.

Fluospot fittings are designed for wall installation, for direct and indirect lighting.

Using the available accessories, they can be installed on (0,5 and 1m) arm support and on a telescopic support as a work-lamp for use in mechanical workshops, building yards, etc.

*FLUOSPOT Luminarias diseñadas para interior y exterior con fuerte ahorro energético, con lámparas compactas.*

*Las lámparas compactas disponen de una excelente relación Lm/W que las hacen adecuadas para alumbrados de larga duración.*

*Fluospot sustituyen a las luminarias de lámparas halógenas, para iluminar fachadas, frentes comerciales, anuncios y lugares comerciales de interior.*

*El tecnopolímero utilizado es resistente a la corrosión y puede instalarse en todos ambientes incluso en marinos.*

*Fluospots luminaria diseñada para instalaciones en fachadas para iluminación directa o indirecta.*

*Utilizando los accesorios, brazos de (0,5 o 1m) en espigas para jardines y en columna telescópica como luminaria portátil de trabajo, construcción civil, talleres, etc.*







### STRUCTURAL CONSTRUCTION

- Polyamide body reinforced with fibreglass, available in black or white RAL 9010.
- Direct to diffuser, CNC applied, dual foam silicone gasket.
- Stabilized UV polycarbonate diffuser.
- Polyamide joint functioning as a connection box. Easy and fast rotation fixing through rack installed on the joint. Fast electrical connection because of the easy external terminal box.
- The reflectors are made in very pure, polished and anodized aluminium, functioning as a support for electrical components.
- Fluospot fittings are complete with bracket and cover for wall installation. The bracket is made in painted sheet steel and cover in matching colour polyamide.
- Stainless steel external screws.

On request, stainless steel anti-vandal TORX screws are available as accessory.

### CARACTERISTICAS DE CONSTRUCCION

- Cuerpo de poliamida reforzado con fibra de vidrio, color blanco RAL 9010, o negro.
- Difusor con junta de silicona directamente aplicada automáticamente, CNC.
- Difusor policarbonato estabilizado a U.V.
- Caja unión de poliamida que sirve para conexiones. Fácil y rápido ajuste por rotación en la unión. Conexionado sencillo en la caja de tape externo.
- Reflector de aluminio puro pulido y anodizado, sirve para sujetar el equipo eléctrico.
- Fluospot se suministra completo con soporte y cubierta para instalar en pared. El soporte está fabricado en acero pintado en el mismo de la poliamida.
- Tornillos externos inox.

Bajo demanda se puede suministrar tornillos TORX como accesorio.

### SBP

### TECHNICAL AND UTILIZATION DATA DATOS TECNICOS Y DE MONTAJE

		Min - 30° ± - 10°C Max + 25° ± + 60°C Ta			IK 09 12 J						
CLASS I		80 85	IP 55					FSD 9W	FSQ 13W	FSS 16W	FSD 24W



**80 85** FLUOSPOT PC

05836013	PC 29	80	CR
05901023	PC 29	85	CR
05835013	PC 49	80	CR
05900023	PC 49	85	CR



G23	2x9W	DULUX-S/PL-S
G23	2x9W	DULUX-S/PL-S
G23	4x9W	DULUX-S/PL-S
G23	4x9W	DULUX-S/PL-S

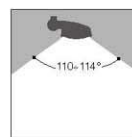
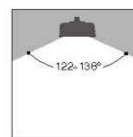
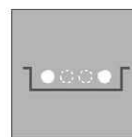

**80 85** FLUOSPOT PC

05837013	PC 213	80	CR
05902023	PC 213	85	CR



G24d-1	2x13W	DULUX-D/PL-C
G24d-1	2x13W	DULUX-D/PL-C

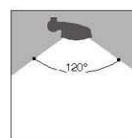
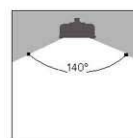
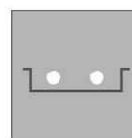

**80 85** FLUOSPOT PC

05892013	PC 16 2D	80	CR
05904023	PC 16 2D	85	CR



2p GR8	16W	2D
2p GR8	16W	2D

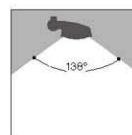
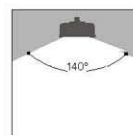
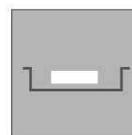

**80 85** FLUOSPOT PC

05893013	PC 24F	80	CR
05903023	PC 24F	85	CR



2G10	24W	DULUX FLAT
2G10	24W	DULUX FLAT

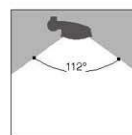
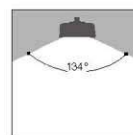
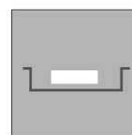

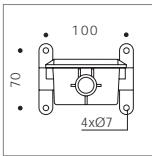

- 14002680 - A0168/500 **80**
- 14002785 - A0168/500 **85**
- 14002880 - A0168/1000 **80**
- 14002985 - A0168/1000 **85**

Die cast aluminium connection box (IP54) and 50/100cm arm in steel painted in black or in white. It allows connection of fittings in series.

*Caja de conexiones de aluminio inyectado IP54 con brazo de 50/100cm. En chapa de acero pintado negro o blanco. Permite la conexión serie.*

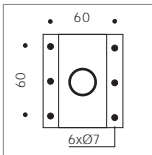

- 14004011 - A113/500 **80**
- 14005021 - A113/500 **85**
- 14323013 - A113/1000/R **80**
- 14324023 - A113/1000/R **85**

50 or 100cm support sheet steel painted in black or white.

*Soporte 50/100cm. Chapa de acero pintado negro o blanco.*

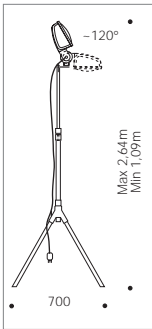

- 14337011 - A107/T **80**

Adjustable telescopic stand in painted steel. Junctions in polyamide.

*Columna telescópica ajustable en acero pintado. Unión de poliamida.*

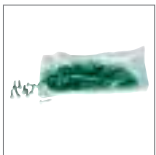

- 14404995 - A0108

Set of 100 stainless steel anti-vandal screws TORX T20H INOX, available on request.

*Conjunto de 100 Tornillos TORX T20H INOX, suministrable bajo demanda.*

